



EBONIZED OAK



PRODUCT DOWNLOADS

RAY SCONCE (DIRECTIONAL)

ALL SIZES SPEC SHEET



UNI J-BOX MOUNTING FOR 2"x4" SWITCHBOX – BACK PLATE REQUIRED

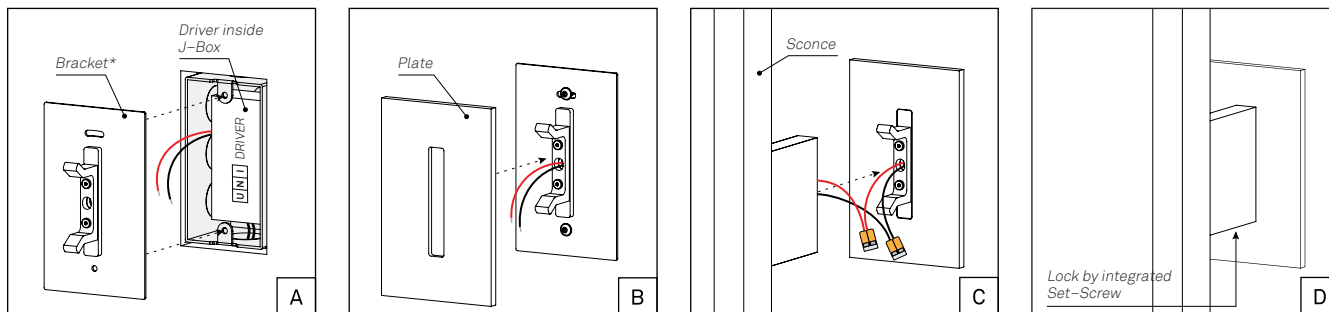

UNI J-BOX MOUNTING FOR 4"x4" JUNCTION BOX – BACK PLATE REQUIRED

+ 2"x4" Switchbox Adapter (sold separately) must be installed before proceeding with steps A - D above

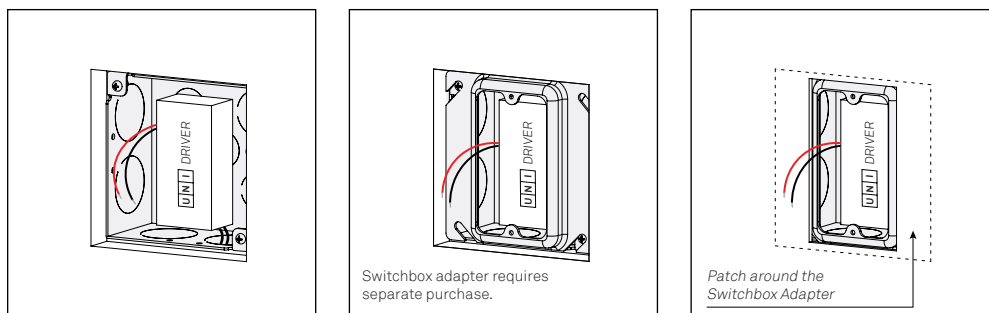

REM DIRECT-WALL MOUNTING – NO BACK PLATE

+ Remote driver application only
+ Requires blocking in wall
+ Cleat mounts directly to wall
+ Guideline Template provided
+ Wire hole: Drill max $\phi 1/4"$ to ensure hole is covered by cleat

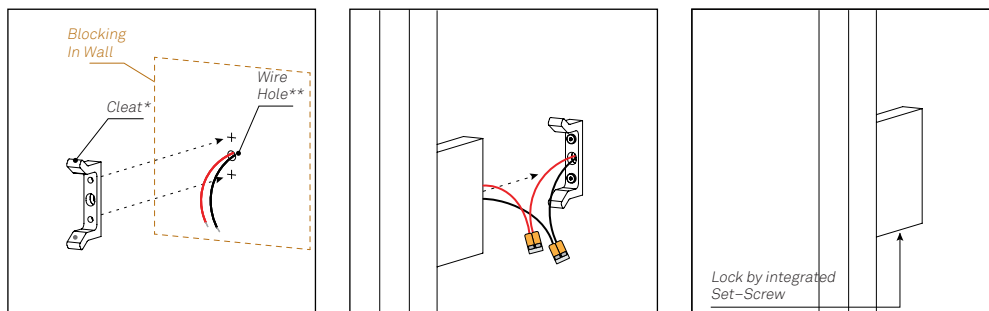

REM DIRECT-WALL MOUNTING – WITH BACK PLATE

+ Remote driver application only
+ Requires blocking in wall
+ Bracket mounts directly to wall
+ Guideline Template provided

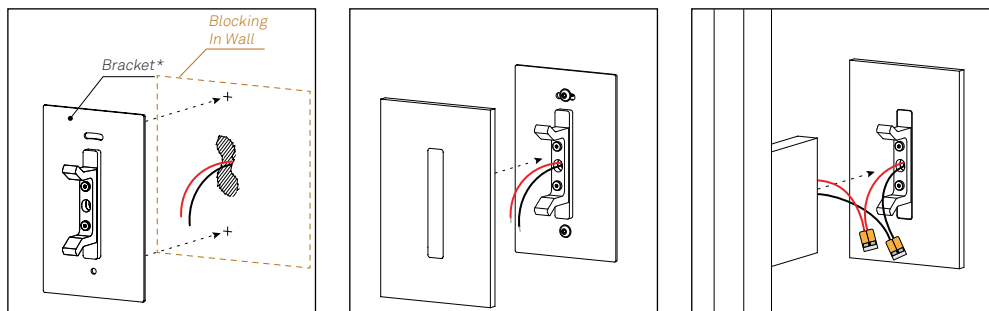

CHOOSING WIRE GAUGE

Use the information below to determine the appropriate wire gauge to lead the driver to the sconces.

WIRE GAUGE	MAXIMUM LEAD LENGTH (10-20V)
24 AWG (0.2 mm ²)	2.5ft (0.8m)
22 AWG (0.34 mm ²)	4ft (1.2m)
20 AWG (0.5 mm ²)	6ft (1.8m)
18 AWG (0.75 mm ²)	10ft (3m)
16 AWG (1.5 mm ²)	15ft (4.5m)
14 AWG (2.5 mm ²)	25ft (7.5m)
12 AWG (4 mm ²)	40ft (12m)

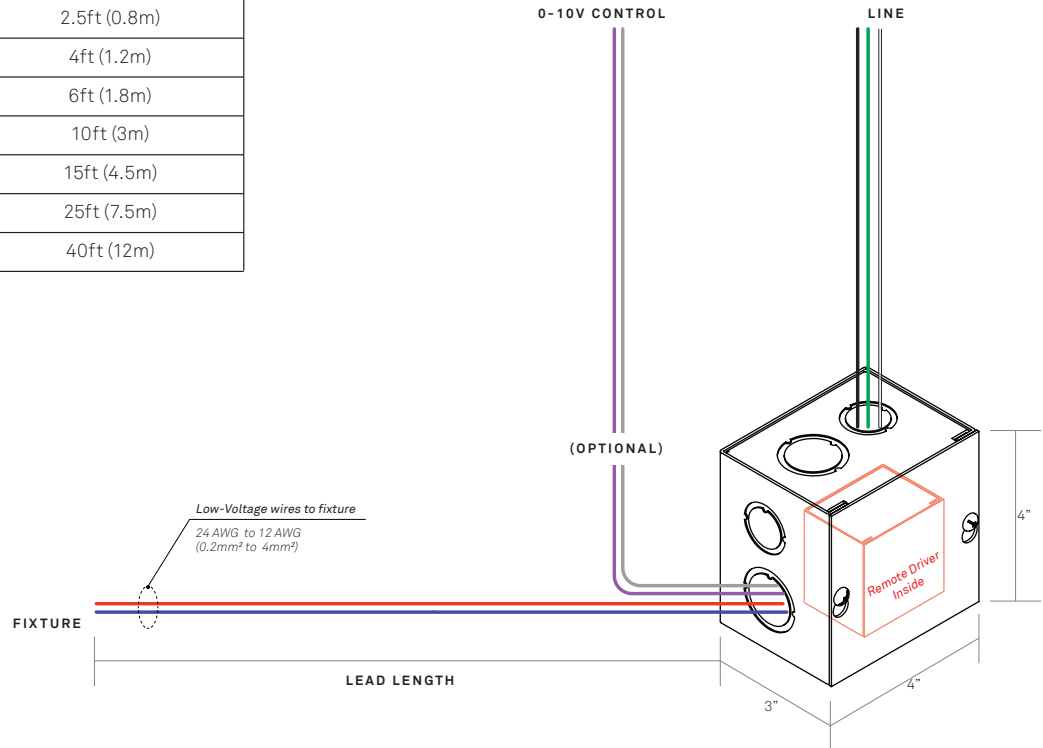

MOUNTING DRIVER ENCLOSURE

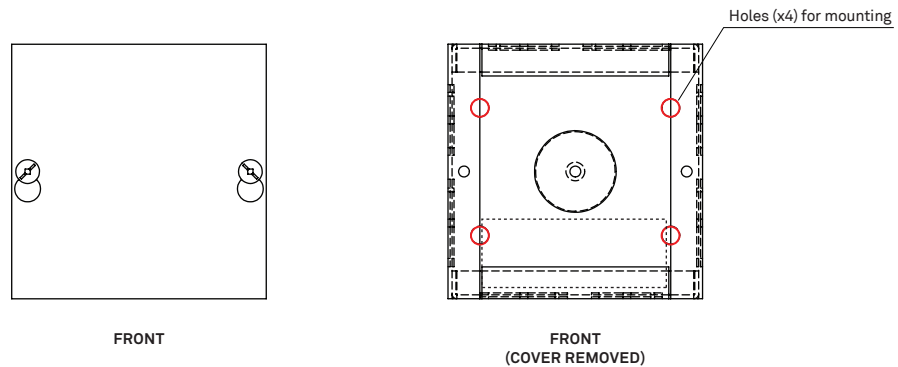

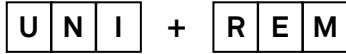

120V-277V driver (Universal dimming including 0-10V)

Manufacture’s specifications (18” and 2’ Ray Sconce):

stickbulb.com/drivers/UNI6

Manufacture’s specifications (3’ Ray Sconce):

stickbulb.com/drivers/UNI8

Manufacture’s specifications (4’ and 5’ Ray Sconce):

stickbulb.com/drivers/UNI12

Low-Voltage Compatible Dimmer brands: Crestron, Lutron, Leviton

For assistance selecting controls, contact LTF at +1 (847) 498-5832 or LTFsales@LTFtechnology.com

Brand	Part number
Crestron	CLS-C6
Crestron	CLS-C6M
Crestron	CLS-C6EX
Crestron	CLS-C6MEX
Crestron	CLS-EXP-DIM
Crestron	CLS-EXP-DIMU
Crestron	CLX-2DIM8
Crestron	DIN-1DIM4
Crestron	DIN-1DIMU4
Crestron	CLW-DIMEX-E
Crestron	CLW-DIMEX-P
Crestron	CLW-DIMSWEX-E
Crestron	CLW-DIMSWEX-P
Crestron	GLX-DIM6
Crestron	GLXX-2DIM8
Crestron	P-DIMEX
Crestron	CLW-DELVEX-E
Crestron	CLW-DELVEX-P

Brand	Part number
Lutron	DVCL-153P
Lutron	DVELV-303P
Lutron	HQRD-6A
Lutron	HQRD-6NA-
Lutron	NTELV-300-
Lutron	NTELV-600-
Lutron	NVELV-600-
Lutron	VTELV-600M
Lutron	MAELV-600-
Lutron	MSCELV-600M
Lutron	MIRELV-600-
Lutron	MRF2-6ELV-120-
Lutron	SELV-300P
Lutron	CTELV-303P
Lutron	SELV-600-

Brand	Part number
Leviton	Model 6615
Leviton	Model 6672
Leviton	Model 6674
Leviton	Model IPL06
Leviton	Model IPE04
Leviton	Model IPI06
Leviton	Model VP106
Leviton	Model VPE04
Leviton	Model VPM06
Leviton	Model VRE04
Leviton	Model VRM10



All of our wood and metal products should be dusted by hand with a dry Swiffer pad (or equivalent) on a regular schedule to maintain surface integrity. It is imperative that none of our products come into contact with bleach, vinegar, lemon juice or any household product which may contain these or other solvents.

If any part of one of our fixtures becomes soiled with dried residue or grime, wipe the affected area with a soft cloth dampened very lightly with warm water and immediately wipe dry with another soft cloth. If this does not complete the task, wipe with a cloth soaked in diluted mild liquid dish soap and again immediately dry.

Fingerprints on our Nickel-plated, Brass-plated, and Blackened metal hardware can be removed with a clean, dry, soft cloth. We recommend an ultra-fine, textureless microfiber cleaning cloth (as one uses to clean glass).

All of our Brass hardware is treated with a protective coating to prevent tarnish. It should need no more than a wipe with a clean, dry, soft cloth to remove fingerprints and dust.

Brushed metal surfaces should be buffed in the direction of the grain.

For scratches in wood we highly recommend Claphams beeswax, which is non-toxic and can be applied by hand. Rub a small amount into the scratch area and buff with a dry cloth.

